

Quick Start Manual beta version

1. 安装 Installation

1.1 安装插座，给插座上电

Plug the Wifi socket into where you want to install and connect it to power.

1.2 安装路由器，并确保路由器可以连接到互联网，如路由器命名为：ETMAN_Router。

Install a router and make sure it can connect to network. Here take an example to name the router as "Etman Router".

1.3 手机下载和安装英特曼 APP,并让手机连接上路由器(如：)。

Download (scan below QR Code or visit <http://export.etman.cn/about.asp?id=146>) and Install APP named "Etman switch" in your phone, and then connect your phone to the router.

Android



IOS



2. 手机操作 Operational Guidelines

2.1 打开手机主屏幕点击“英特曼插座”,启动程序.
Click on the icon “Etman switch” to start.



2.2 登陆 APP

Log on APP by entering user name and password.
Register an account first when first time use.

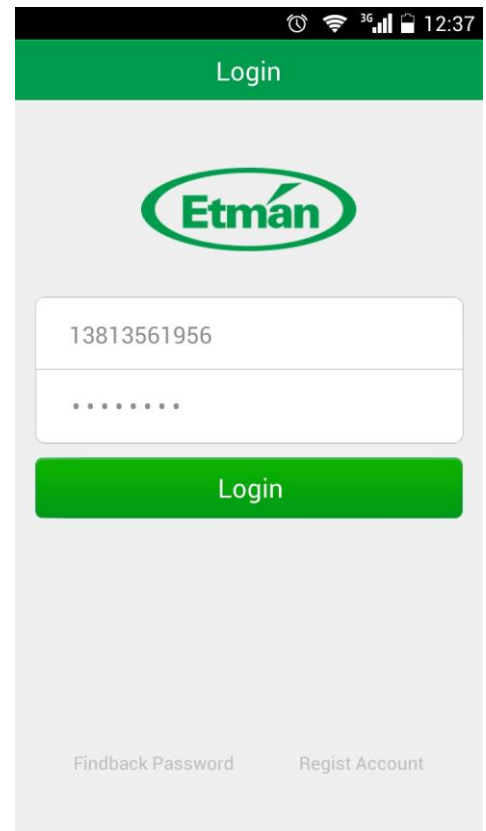

2.3 登陆后就显示已添加的设备列表 You can see the device list after logging on.

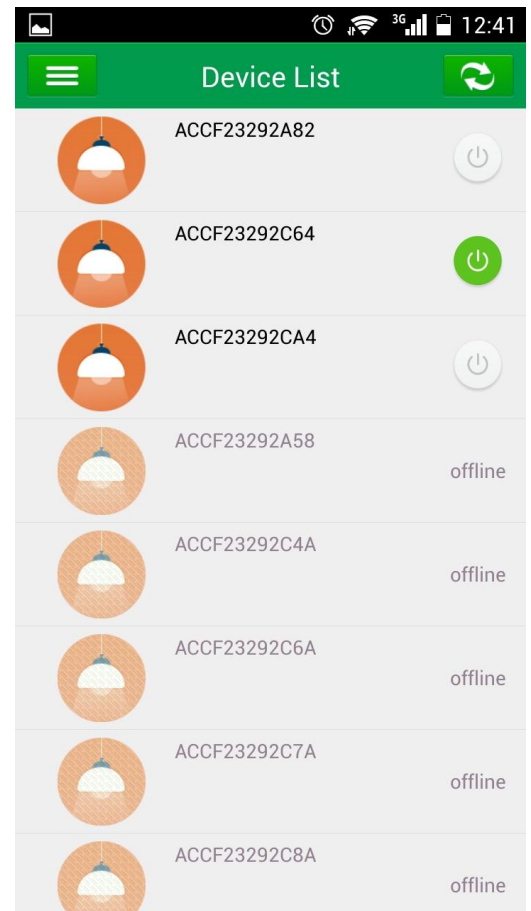

2.4 添加新设备 How to add device

- 1) 长按产品的按键 , 大约 5 秒钟左右, 绿色灯在闪烁时松手, 此时产品进入设置状态.

Press the button  on the Wifi socket for about five seconds until button twinkling in green light, which show that the Wifi socket is in set condition.

- 2) 在 APP 点“ADD Device”, 进入配置页面.
Click on the iron “Add Device” as the picture showing below and enter in the set page.
- 3) 输入此前连接的路由器密码, 可选择配置单个或多个设备, 然后点“configure”
Input the router password. You can choose single or multiple to add one or more devices, and then click on the iron “configure”.



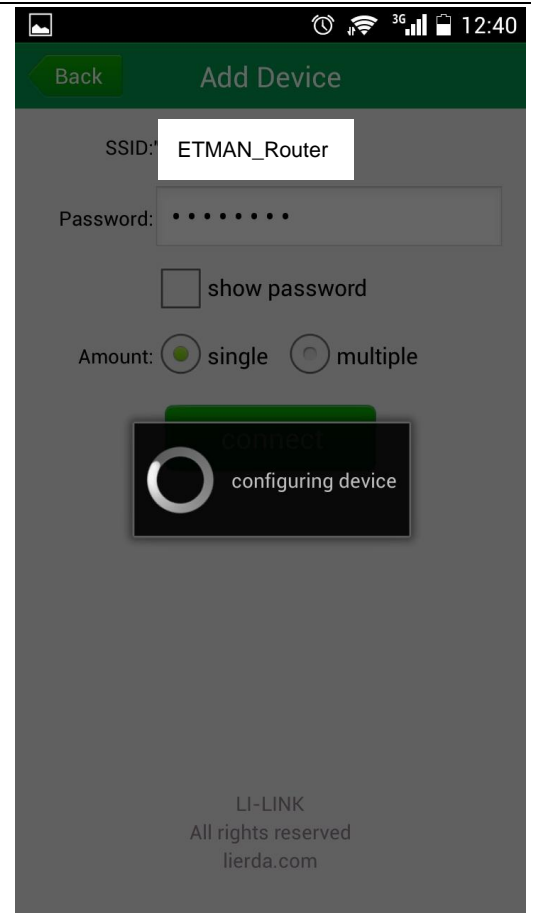
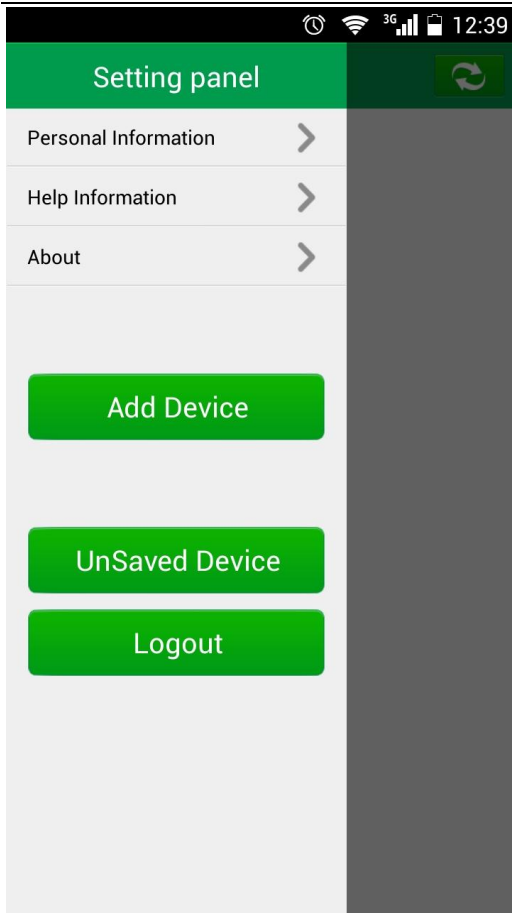

2.5 打开关闭设备

How to turn on or off the device

在设备列表里面, 点击设备后面小按钮就可以打开或关闭设备。

Click on the icon  shown as the picture right to turn on or off the device.

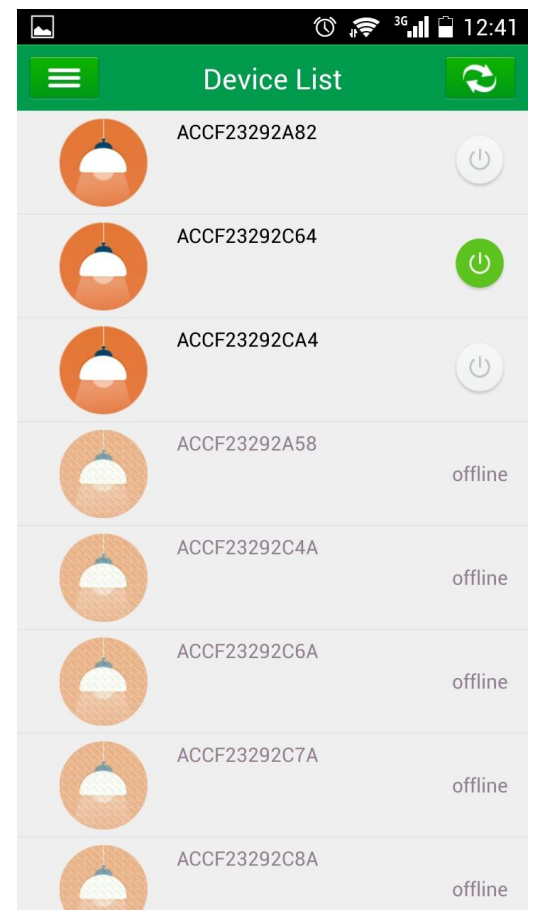

2.6 定时功能

Timer setting

在点击设备列表每一列的设备图标，可以进入设备编辑状态

点击“add timer”，可以进入定时管理

Click on the device you want to set and enter into the device set condition. Click on the iron “add timer” to enter into timer setting.

